









LEGENDA

-  BLOCO INTERTRAVADO PARA VIA H= 10 CM
-  BLOCO INTERTRAVADO CALÇADA H= 6 CM
-  CALÇAMENTO EXISTENTE
-  GRAMA
-  MATA-BURRO
-  MEIO-FIO COM SARJETA
-  MEIO-FIO SEM SARJETA
-  CALHA MEIA-CANA 0,30 x 0,30
-  TRINCHEIRA FILTRANTE DRENO COM TUBO PERFURADO E MANTA BIDIN

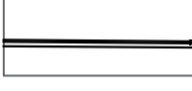
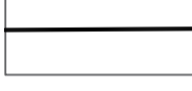
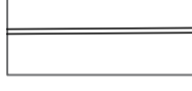
TRECHOS PARA PAVIMENTAÇÃO		
Vias	PAVIMENTO INTERTRAVADO	MEIO-FIO
A	223,05 m <sup>2</sup>	64,06 m
B	103,33 m <sup>2</sup>	25,27 m
C	50,40 m <sup>2</sup>	23,74 m
D	135,37 m <sup>2</sup>	65,18 m
E	188,88 m <sup>2</sup>	98,63 m
F	238,70 m <sup>2</sup>	28,26 m
G	359,85 m <sup>2</sup>	120,00 m
H	950,68 m <sup>2</sup>	296,74 m
I	267,69 m <sup>2</sup>	102,77 m
J	267,69 m <sup>2</sup>	147,51m
<b>Subtotal</b>	<b>2.914,05 m<sup>2</sup></b>	<b>1006,08 m</b>
<b>Calçadas</b>		
Trevo	30,00 m <sup>2</sup>	
Prédio	146,00 m <sup>2</sup>	85,96 m
Subtotal	176,00 m <sup>2</sup>	85,96 m
<b>Total geral:</b>	<b>3.091,00 m<sup>2</sup></b>	<b>1.092,04 m</b>

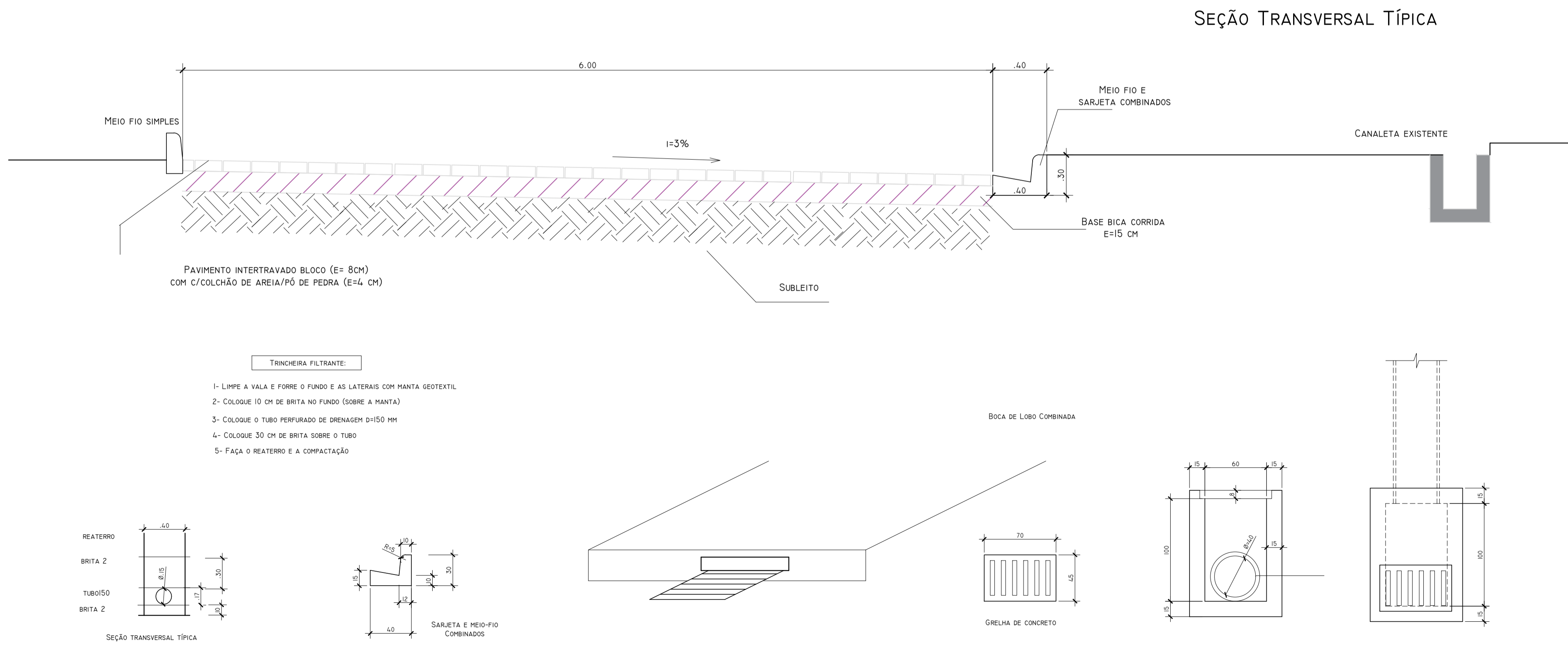

SEÇÃO TRANSVERSAL TÍPICA

PROJETO DE PAVIMENTAÇÃO COM BLOCOS DE CONCRETO INTERTRAVADO, MEIO-FIO E DRENAGEM DO ACESSO AO PRÉDIO DE GRADUAÇÃO DO INSTITUTO FEDERAL DE EDUCAÇÃO DO RIO DE JANEIRO - CAMPUS PINHEIRAL - IFRJ

ÁREAS:

TOTAL CONSTRUÍDA  
3091 m<sup>2</sup> de área descoberta



DIRETOR GERAL: \_\_\_\_\_  
 AUTOR DO LEVANTAMENTO: \_\_\_\_\_  
 RESP. TÉCNICO: \_\_\_\_\_

ASSUNTO:  
 PLANTA BAIXA E TABELAS